

AquaLIGHT 306

Unleashing Brilliance Everywhere.



The main colors of RGB lights—red, green, and blue—are each meticulously measured for their brightness levels. This careful calibration ensures that our AquaLIGHT 306 provides uniform brightness, resulting in a seamless and homogeneous color combination. This feature is particularly beneficial in applications such as open space fountains, where consistent and vibrant lighting can dramatically enhance the aesthetic appeal of the water displays.

AquaLIGHT 306 is designed to deliver high efficiency and reliability, making it an ideal choice for outdoor installations. The product comes equipped with advanced temperature control and thermal protection mechanisms. These features not only protect the light from overheating but also make dry installation possible, providing flexibility in various environmental conditions. This makes the AquaLIGHT 306 not just a lighting solution but a robust and versatile tool for creating stunning visual effects in open spaces.



- ✓ Edison PowerLED
- ✓ Driver circuit onboard
- ✓ Aluminium PCB
- ✓ IP68
- ✓ Robust stainless steel
- ✓ Tempered glass
- ✓ DMX + RDM controlled
- ✓ Synchronorm Depence Library available

AquaLIGHT 306



ACCESSORIES

PRODUCT	ORDER NO
BlackBox :	5022
Combo Cable :	page
ByPass Terminal :	page
Comet Nozzle :	page
Holder U Profile :	3079
Holder Lighting :	3078
Multi Lighting Kit 2 :	3080
Multi Lighting Kit 3 :	3090

TECHNICAL DETAILS

MODEL :	AquaLIGHT 306
DIMENSION (ØxH) :	160 x 70 mm
VOLTAGE :	24 VDC
POWER :	16.5 W
CURRENT :	0.7 A
COLORS :	RGB
POWER & DMX :	Combo Cable
LUMINOUS FLUX RGB FULL :	1025 lm
WEIGHT :	0.8 kg
PRODUCT NO :	3021

Lighting Angle:

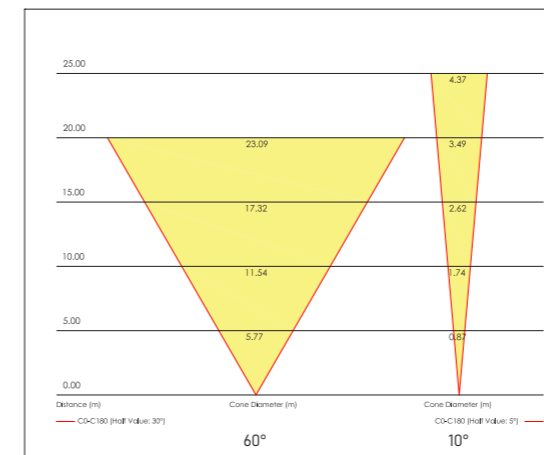

Schematic :

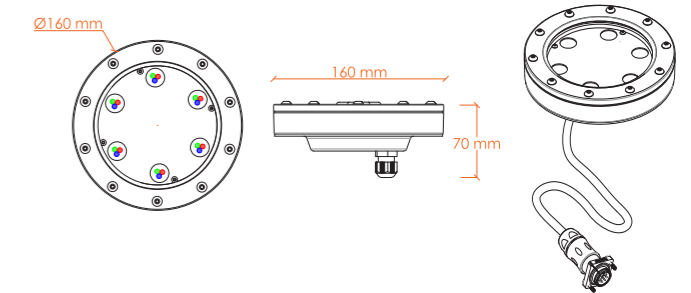

Holder U Profile Schematic :

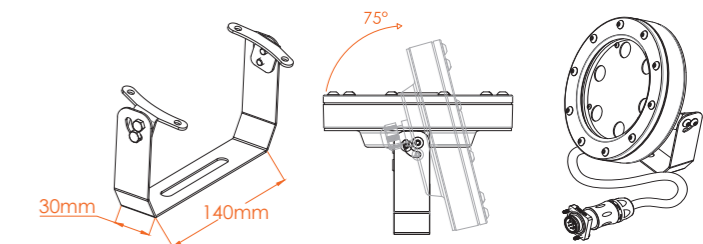

! In lighting, choosing the lens angle is as important as selecting the color or wattage. Small angles retain brightness at long distances, while wide angles cover larger areas but lose brightness over distance.

Connection Schematic :

